



# The future of the forest is in your hands!

We all have a role to play in land stewardship. Whether you are a student, landowner, or interested in volunteering, you can make a difference in central Wisconsin.

If you do not own land, consider the management of public lands where you hike, hunt, or fish. Connect with the land managers of the property, learn about their management objectives, and ask them how you can help. Also, be sure to buy certified sustainably managed paper and wood products.

If you own a woodland in Wisconsin, there are a number of programs and organizations that can provide stewardship guidance for you and your woods.



### Managed Forest Law:

State program for forest management and property tax benefits. [dnr.wi.gov](http://dnr.wi.gov) keyword MFL



### WI Tree Farm:

Program that supports sustainable forest management. [www.witreefarm.org](http://www.witreefarm.org)



### My Wisconsin Woods

A public, private partnership serving woodland owners across Wisconsin. [mywisconsinwoods.org](http://mywisconsinwoods.org)



### Deer Management Assistance Program:

State program for learning how to improve habitat and manage wildlife. [dnr.wi.gov](http://dnr.wi.gov) keyword DMAP



### Wisconsin Woodland Owners Association:

Educational community of fellow woodland owners and professionals. [wisconsinwoodlands.org](http://wisconsinwoodlands.org)



### EQIP / CSP:

Federal cost share for forest and habitat improvement. [www.wi.nrcs.usda.gov](http://www.wi.nrcs.usda.gov)

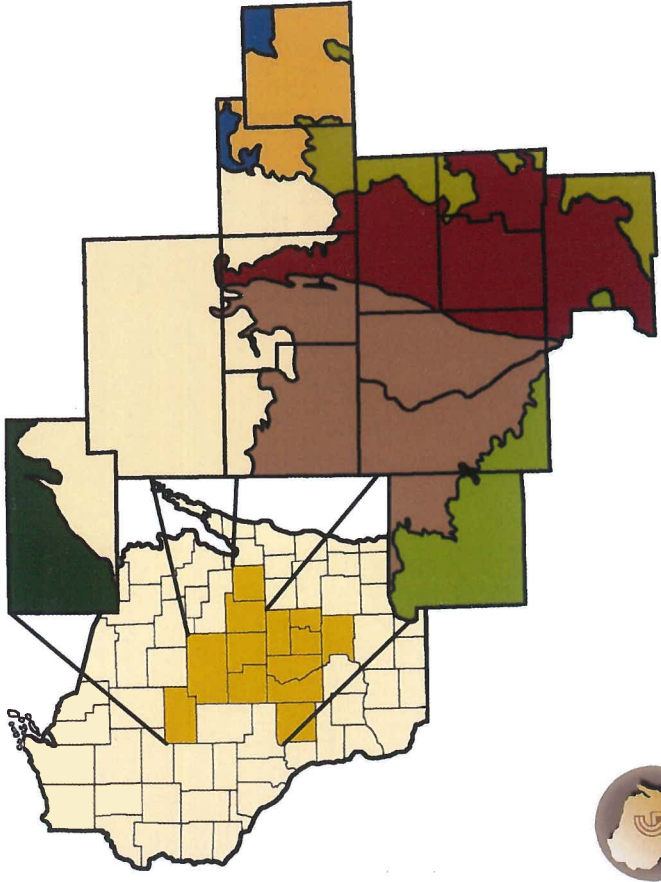

### Golden Sands RC&D Ecological Landscapes

- North Central Forest
- Forest Transition
- Central Sand Plains
- Western Coulees & Ridges
- Northern Lake Michigan Coastal
- Central Lake Michigan Coastal
- Southeast Glacial Plains
- Central Sand Hills

Golden Sands RC&D is a regional conservation 501(c)3 nonprofit. We work in 13 counties in central Wisconsin that contain eight different ecological landscapes. The Pinevilla Tree Farm serves as an example of a Central Lake Michigan Coastal Ecological Landscape. We encourage you to visit our website to learn more

about other Demonstration Forests and to get involved in woodland and wildlife habitat management. Our website provides information about land management programs, cost share for habitat improvement, and/or tax benefits. There are lots of ways you can get involved in the land management movement in Wisconsin. We want to help landowners connect to state and federal programs that will work for them. With proper forest management, we hope more landowners across Wisconsin see the benefits of productive and healthy forests and wildlife habitat.

[www.goldensandsrcd.org/livingclassrooms](http://www.goldensandsrcd.org/livingclassrooms)

Questions? Call our office: 715-343-6215

Printed: January 2021

This organization is an equal opportunity provider.

# Adams County



# Demonstration FOREST

# Hendricksen Woodland

This is private property! Please call Golden Sands RC&D to schedule a free site visit with the landowner.



The Golden Sands RC&D

Demonstration Forest Network

"Connecting Communities to Land Stewardship"  
[www.goldensandsrcd.org/livingclassrooms](http://www.goldensandsrcd.org/livingclassrooms)  
 715-343-6215

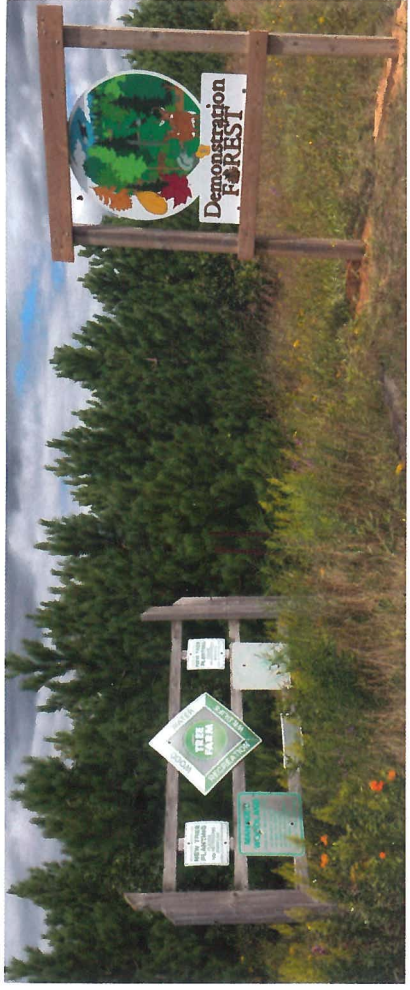

## Welcome to the Hendricksen Woodland!

In the 1950s Spencer and Laura Munson purchased land that consisted of old farm fields. They named the property the "Full Cycle Tree Farm," and restored the property to pre-European settlement forest. Their daughter Nancy Livingston later inherited the property and viewed her work on the tree farm as an opportunity to educate students and community members about sustainable forest management. Over the years she held numerous field days for fourth grade students to learn about land stewardship. Her primary goal was to maintain the integrity of the land and to share the place she loved with others.

In 2005 the property was devastated by the Cottonville fire which consumed over 3,400 acres in Adams County. What had been a thriving tree farm was left as bare as the day her parents acquired the land. Undeterred by the new challenge, Nancy revised her Managed Forest Law (MFL) plan and dedicated her time to restoring the beauty and productivity of the tree farm, developing habitat for wildlife including the endangered Karner blue butterfly and protecting the Big Roche-A-Cri Creek watershed, a class 1 trout stream. As a result of hard work, the parcel demonstrates the use of natural regeneration and tree planting and has forested, riparian and prairie land cover types.

Today, the property is known as the Hendricksen Woodland and is owned and managed by Richard and Cleo Hendricksen, friends and neighbors of Nancy's. It is their goal to continue managing the property following Nancy's family's legacy. Following Nancy's objectives, the Hendricksens continue to manage the prairie for Karner blue butterflies.

## The Hendricksen Woodland Tour

**Area 1: Reforestation and Fire**  
This site was originally a farm field but was reforested by Nancy and her family through active tree planting. In 2005 the fire, a natural disturbance, removed all of the trees and left the ground barren. It has since been replanted with Norway pine.

**Area 2: Fire Lane**  
After the fire, this section of the property was used as a fire lane and was never replanted. The crews who removed debris from the fire used this path to reduce ground compaction as they cleared the fire debris in preparation for the site's future tree plantings.

**Area 3 and 8: Oak and Norway Pine**  
This area has been sparsely planted with red, white and bur oak and Norway pine. The majority of the trees naturally regenerated following the fire. Land managers are encouraged to monitor the condition of red oak trees which are susceptible to oak wilt caused by a fungus. Diseased trees should be removed to protect the healthy surrounding trees from infection. They can be recognized by autumn colored leaves in the summer.

**Area 4: Stewardship Days**  
This area of the property is used for educational purposes. For more than 15 years school groups have visited the property to learn about land stewardship and help plant trees. The site is composed of Norway pine, white pine, spruce and jack pine planted in part by 4th grade classes over the years.

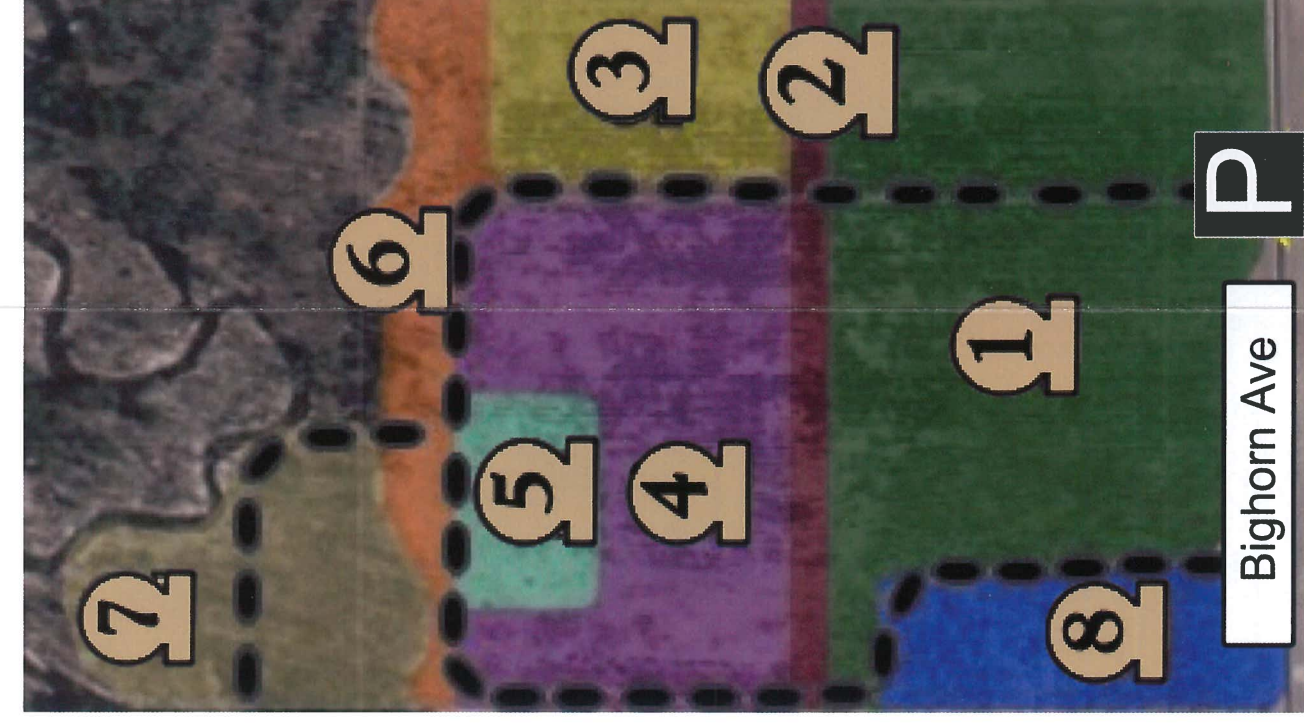

**Area 5: Habitat for Kirtland Warblers**  
This section is composed of jack pine and managed to create and maintain habitat for Kirtland warblers, a federally endangered species. These small song birds are yellow and slate gray in coloration and feed on insects. Jack pine are important for warbler breeding. Although the Cottonville fire devastated the property, certain species including jack pine rely on fire for seed germination. Heat from fire is required to open the cones and to release the seeds.

**Area 6: Prairie for Karner Blue Butterflies**  
This site was restored for Karner blue butterfly habitat. This small butterfly is comparable to the size of a quarter and is dependent on a plant called lupine. Karners rely on lupine to lay their eggs and for food. Other wild flowers in the area include wild bergamot, goldenrod and black-eyed susan.

**Area 7: Riparian Bliss**  
This section of the property abuts the Big Roche-A-Cri creek. The area is characterized by steep forested slopes that angle down to the water's edge. The combination of the steep terrain and lower lying forested areas makes it difficult to log. Adjustments to the forest management plan were made to prevent degradation of the fragile slopes. The tree species along the creek include a collection of maples, oaks and large white pines.

Thank you to these Demonstration Forest sponsors!



**RUFFED  
GROUSE  
SOCIETY**



Caring for Our Corner of the Earth

Natural Resources  
FOUNDATION  
of Wisconsin